

Unmatched Quality & High Performance LUGs



**National Price List
w.e.f - 01.02.2023**



We would like to introduce ourselves as manufacturers of export quality Copper & Aluminum Lugs as per International Standards. Our products are CE approved for following standards

DIN46234, DIN46235, IEC61238, AS/NZ, Indian Standards

As a company its our policy to be Ethical, Consistent & Competitive.

Our products are of very high quality giving lowest millivolt drop across crimp connection to give you low heating used in DC current & Continuous High Current applications.

Our product strengths are

- > 100% EC Grade Copper Raw Material
- > Excellent Crimpability due to perfect annealing
- > Bur Free Surface to give good contact area.
- > 5 Micron plus Tin Plating to avoid oxidation
- > Crack free crimping.
- > Batch code for traceability.

Our Others Strenghts

- > Own toolroom to make customized lugs.
- > Professional organisation.
- > IATF certified for automative customers

**MG Copper Ring
Type Terminals
(NON-INSULATED)**



**MG Copper Ring
Type Terminals
(Insulated)**

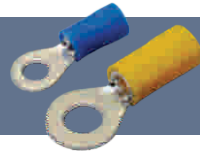

**MG Copper Ring
Type Terminals
(Reinforcement)**



CABLE mm ²	STUD HOLE	PROD. CODE	RATE / PCS.
0.5	3.2	MGR - 0.5 E-3	4.15
0.5	4.2	MGR - 0.5 E-4	4.15
0.75	4.2	MGR - 0.75-4	3.90
0.75	5.2	MGR - 0.75-5	3.90
1	4.2	MG - 001	3.75
1.5	3.2	MGR - 7153	1.95
1.5	3.7	MGR - 7048	1.98
1.5	4.2	MGR - 7049	1.78
1.5	2.2	MGR - 7103	2.18
1.5	2.6	MGR - 7000	2.17
1.5	3.2	MGR - 7001	1.84
1.5	3.7	MGR - 7002	1.84
1.5	4.2	MGR - 7003	1.71
1.5	4.2	MGR - 7154	2.98
1.5	3.2	MGR - 7104	2.47
1.5	4.2	MGR - 7004	2.17
1.5	5.2	MGR - 7005	2.04
1.5	4.2	MGR - 7105	3.05
1.5	5.2	MGR - 7006	2.70
1.5	6.4	MGR - 7007	2.55
1.5	6.4	MGR - 7106	3.12
2.5	3.2	MGR - 7107	2.19
2.5	3.7	MGR - 7008	2.03
2.5	3.7	MGR - 7108	2.68
2.5	4.2	MGR - 7009	2.52
2.5	5.2	MGR - 7010	2.34
2.5	5.2	MGR - 7109	3.03
2.5	6.4	MGR - 7011	2.76
2.5	5.2	MGR - 7110	4.34
2.5	6.4	MGR - 7012	3.93
2.5	8.2	MGR - 7013	3.63
2.5	6.4	MGR - 7111	6.16
2.5	8.2	MGR - 7014	5.36
2.5	10.2	MGR - 7015	5.15
2.5	10.2	MGR - 7151	6.76
2.5	12.7	MGR - 7047	6.38
4-6	4.2	MGR - 7155	4.42
4-6	5.2	MGR - 7050	4.19
4-6	4.2	MGR - 7112	5.73
4-6	5.2	MGR - 7016	5.46
4-6	5.2	MGR - 7113	5.88
4-6	6.4	MGR - 7017	5.64
4-6	8.2	MGR - 7018	5.07
4-6	5.2	MGR - 7114	6.50
4-6	6.4	MGR - 7019	6.29
4-6	5.2	MGR - 7157	7.40
4-6	6.4	MGR - 7115	7.65
4-6	8.2	MGR - 7020	7.08
4-6	9.7	MGR - 7021	6.72
4-6	8.2	MGR - 7116	9.69
4-6	10.2	MGR - 7022	9.49
4-6	8.2	MGR - 7117	10.65
4-6	10.2	MGR - 7023	10.65
4-6	12.7	MGR - 7024	9.18

CABLE mm ²	STUD HOLE	PROD. CODE	RATE / PCS.
1.5	3.2	MGRI - 7057	2.66
1.5	3.7	MGRI - 7058	2.69
1.5	4.2	MGRI - 7059	2.52
1.5	2.2	MGRI - 7052	2.98
1.5	2.6	MGRI - 7053	2.93
1.5	3.2	MGRI - 7054	2.68
1.5	3.7	MGRI - 7055	2.67
1.5	4.2	MGRI - 7056	2.52
1.5	4.2	MGRI - 7063	3.98
1.5	3.2	MGRI - 7060	3.15
1.5	4.2	MGRI - 7061	3.04
1.5	5.2	MGRI - 7062	2.85
1.5	4.2	MGRI - 7064	3.78
1.5	5.2	MGRI - 7065	3.55
1.5	6.4	MGRI - 7066	3.44
1.5	6.4	MGRI - 7067	4.13
2.5	3.2	MGRI - 7068	3.06
2.5	3.7	MGRI - 7069	2.93
2.5	3.7	MGRI - 7070	3.56
2.5	4.2	MGRI - 7071	3.47
2.5	5.2	MGRI - 7072	3.27
2.5	5.2	MGRI - 7073	3.97
2.5	6.4	MGRI - 7074	3.73
2.5	5.2	MGRI - 7075	5.22
2.5	6.4	MGRI - 7076	5.02
2.5	8.2	MGRI - 7077	4.70
2.5	6.4	MGRI - 7078	7.25
2.5	6.4	MGRI - 7079	6.59
2.5	8.2	MGRI - 7080	6.36
2.5	10.2	MGRI - 7081	8.13
2.5	12.7	MGRI - 7082	7.73
4-6	4.2	MGRI - 7083	6.15
4-6	5.2	MGRI - 7084	5.90
4-6	4.2	MGRI - 7085	7.58
4-6	5.2	MGRI - 7086	7.29
4-6	5.2	MGRI - 7088	7.58
4-6	6.4	MGRI - 7089	7.51
4-6	8.2	MGRI - 7090	6.87
4-6	5.2	MGRI - 7087	8.58
4-6	6.4	MGRI - 7091	8.38
4-6	5.2	MGRI - 7092	8.02
4-6	6.4	MGRI - 7093	9.67
4-6	8.2	MGRI - 7094	8.75
4-6	9.7	MGRI - 7095	8.61
4-6	8.2	MGRI - 7096	12.42
4-6	10.2	MGRI - 7097	11.80
4-6	8.2	MGRI - 7098	12.64
4-6	10.2	MGRI - 7099	12.88
4-6	12.7	MGRI - 7100	11.23

CABLE mm ²	STUD HOLE	PROD. CODE	RATE / PCS.
1.5	3.2	MGRR - 7440	3.87
1.5	3.7	MGRR - 7441	3.81
1.5	4.2	MGRR - 7442	3.39
1.5	2.2	MGRR - 7435	3.92
1.5	2.6	MGRR - 7436	3.91
1.5	3.2	MGRR - 7437	3.75
1.5	3.7	MGRR - 7438	3.86
1.5	4.2	MGRR - 7439	3.83
1.5	4.2	MGRR - 7446	5.14
1.5	3.2	MGRR - 7443	4.27
1.5	4.2	MGRR - 7444	3.98
1.5	5.2	MGRR - 7445	3.92
1.5	4.2	MGRR - 7447	5.04
1.5	5.2	MGRR - 7448	4.73
1.5	6.4	MGRR - 7449	4.53
2.5	6.4	MGRR - 7450	5.28
2.5	3.2	MGRR - 7451	3.98
2.5	3.7	MGRR - 7452	3.87
2.5	3.7	MGRR - 7453	4.98
2.5	4.2	MGRR - 7454	4.29
2.5	5.2	MGRR - 7455	4.12
2.5	5.2	MGRR - 7456	4.87
2.5	6.4	MGRR - 7457	4.55
2.5	5.2	MGRR - 7458	6.28
2.5	6.4	MGRR - 7459	5.91
2.5	8.2	MGRR - 7460	5.52
2.5	6.4	MGRR - 7461	8.25
2.5	8.2	MGRR - 7462	7.41
2.5	10.2	MGRR - 7463	7.19
2.5	10.2	MGRR - 7464	9.12
2.5	12.7	MGRR - 7465	8.56
4-6	4.2	MGRR - 7466	7.83
4-6	5.2	MGRR - 7467	7.57
4-6	4.2	MGRR - 7468	9.52
4-6	5.2	MGRR - 7469	9.22
4-6	5.2	MGRR - 7471	9.92
4-6	6.4	MGRR - 7472	9.56
4-6	8.2	MGRR - 7473	9.08
4-6	5.2	MGRR - 7474	10.35
4-6	6.4	MGRR - 7475	10.06
4-6	5.2	MGRR - 7470	10.64
4-6	6.4	MGRR - 7476	11.80
4-6	8.2	MGRR - 7477	11.21
4-6	9.7	MGRR - 7478	10.58
4-6	8.2	MGRR - 7479	15.03
4-6	10.2	MGRR - 7480	13.75
4-6	8.2	MGRR - 7481	14.91
4-6	10.2	MGRR - 7482	14.67
4-6	12.7	MGRR - 7483	13.13

“ Our vision is to become a
Global Brand in Connectors ”

MG Copper Ring Type Terminals (Non-Insulated)

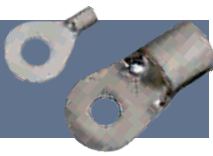

MG Copper Ring Type Terminals (Non-Insulated)



CABLE mm ²	STUD HOLE	PROD. CODE	RATE / PCS.
10	4.2	MGR - 7118	8.98
10	5.2	MGR - 7025	7.88
10	4.2	MGR - 7119	6.67
10	5.2	MGR - 7026	6.18
10	6.4	MGR - 7120	7.23
10	8.2	MGR - 7121	9.26
10	8.2	MGR - 7122	10.79
10	10.2	MGR - 7027	11.49
10	10.2	MGR - 7123	15.44
10	12.7	MGR - 7028	13.05
16	5.2	MGR - 7124	11.31
16	5.2	MGR - 7125	12.89
16	6.4	MGR - 7029	12.22
16	6.4	MGR - 7126	15.39
16	8.2	MGR - 7030	14.79
16	9.7	MGR - 7031	13.99
16	8.2	MGR - 7127	17.67
16	10.2	MGR - 7032	16.71
16	10.2	MGR - 7128	19.55
16	12.7	MGR - 7033	19.34
25	6.4	MGR - 7156	27.14
25	8.2	MGR - 7051	27.56
25	6.4	MGR - 7129	30.11
25	8.2	MGR - 7034	28.08
25	10.2	MGR - 7035	28.26
25	6.4	MGR - 7130	29.30
25	8.2	MGR - 7036	30.13
25	10.2	MGR - 7131	33.98
25	10.2	MGR - 7132	40.95
25	12.7	MGR - 7037	42.56
35	6.4	MGR - 7133	34.46
35	8.2	MGR - 7038	33.28
35	8.2	MGR - 7134	40.33
35	10.2	MGR - 7039	38.90
35	10.2	MGR - 7135	44.75
35	12.7	MGR - 7040	45.97

CABLE mm ²	STUD HOLE	PROD. CODE	RATE / PCS.
50	8.2	MGR - 7136	56.98
50	10.2	MGR - 7041	53.33
50	10.2	MGR - 7137	59.24
50	10.2	MGR - 7138	66.98
50	12.7	MGR - 7042	66.54
50	16.2	MGR - 7139	78.90
70	10.2	MGR - 7140	80.52
70	12.7	MGR - 7043	76.76
70	12.7	MGR - 7141	80.64
70	16.2	MGR - 7142	94.35
95	10.2	MGR - 7143	99.89
95	10.2	MGR - 7144	110.60
95	12.7	MGR - 7044	109.28
95	16.2	MGR - 7145	128.18
120	12.7	MGR - 7146	144.98
120	20.3	MGR - 7148	210.81
150	12.7	MGR - 7149	286.10
150	16.2	MGR - 7045	281.50
150	16.2	MGR - 7150	321.32
150	20.3	MGR - 7046	310.57



Open Barrel Chain Type Lug



Mid-Joint Brass Terminal



Snap-on Female Terminal



MG Copper Open-close Type Soldering Terminal

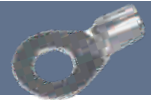

CABLE mm ²	STUD HOLE	PROD. CODE	RATE / PCS.
1.5	4.2	MGOC - 371	2.95
2.5	5.2	MGOC - 372	3.95
4	5.2	MGOC - 373	5.55
6	6.5	MGOC - 374	7.82
10	6.5	MGOC - 375	9.77
16	8.2	MGOC - 376	16.16
25	8.2	MGOC - 377	31.82
35	8.2	MGOC - 378	41.15
50	10.2	MGOC - 379	67.74
70	10.2	MGOC - 380	109.60

MG Copper Fork Type Terminal (Non-Insulated)



MG Copper Fork Type Terminals (Insulated)



CABLE mm ²	STUD HOLE	PROD. CODE	RATE / PCS.
0.75	3.5	MGF - 0.75	4.10
1	3.4	MGF - 1	3.92
1.5	3.5	MGF - 7249	1.92
1.5	3	MGF - 7250	3.34
2.5	3.5	MGF - 7251	2.31
2.5	5	MGF - 7280	5.43
4-6	3.1	MGF - 7252	3.62
4-6	3.5	MGF - 7253	3.61
10	6.5	MGF - 7254	13.90
10	8.2	MGF - 7255	12.75

CABLE mm ²	STUD HOLE	PROD. CODE	RATE / PCS.
1.5	3.5	MGFI - 7926	2.78
1.5	3	MGFI - 7927	3.92
2.5	3.5	MGFI - 7928	3.27
2.5	5	MGFI - 7929	6.70
4-6	3.1	MGFI - 7930	5.27
4-6	3.5	MGFI - 7931	5.27
10	6.5	MGFI - 7932	18.17
10	8.2	MGFI - 7933	17.74

MG Copper Fork Type Terminals (Reinforcement)



CABLE mm ²	STUD HOLE	PROD. CODE	RATE / PCS.
1.5	3.5	MGFR - 7935	3.67
1.5	3	MGFR - 7936	4.59
2.5	3.5	MGFR - 7937	4.09
2.5	5	MGFR - 7938	7.80
4-6	3.1	MGFR - 7939	7.50
4-6	3.5	MGFR - 7940	7.50
10	6.5	MGFR - 7941	23.11
10	8.2	MGFR - 7942	22.54

MG Copper Pin Type Terminals (Non-Insulated)



CABLE mm ²	STUD HOLE	PROD. CODE	RATE / PCS.
0.5	-	MGP - 0.5	3.66
0.75	-	MGP - 0.75	2.68
1	-	MGP - 26	2.74
1.5	-	MGP - 35	1.95
1.5	-	MGP - 9	2.13
2.5	-	MGP - 1	2.29
2.5	-	MGP - 2	2.13
4	-	MGP - 3	5.09
4	-	MGP - 4	4.94
6	-	MGP - 5	5.43
6	-	MGP - 6	7.10
10	-	MGP - 7	8.08
16	-	MGP - 8	14.33
25	-	MGP-25	33.90
35	-	MGP-135	39.67
50	-	MGP - 50	58.63
70	-	MGP - 70	84.95
95	-	MGP-95	127.82

MG Copper Pin Type Terminals (Insulated)

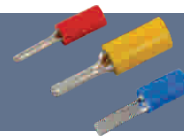

CABLE mm ²	STUD HOLE	PROD. CODE	RATE / PCS.
1.5	-	MGPI - 17	3.01
1.5	-	MGPI - 40	2.78
2.5	-	MGPI - 18	3.21
2.5	-	MGPI - 19	2.87
4	-	MGPI - 20	6.90
4	-	MGPI - 21	6.72
6	-	MGPI - 22	7.27
6	-	MGPI - 23	8.22
10	-	MGPI - 24	11.80
16	-	MGPI - 25	19.46

MG Copper Pin Type Terminals (Reinforcement)



CABLE mm ²	STUD HOLE	PROD. CODE	RATE / PCS.
1.5	-	MGPR - 26	3.77
1.5	-	MGPR - 40	4.04
2.5	-	MGPR - 27	4.04
2.5	-	MGPR - 28	3.97
4	-	MGPR - 29	8.57
4	-	MGPR - 30	9.54
6	-	MGPR - 31	9.18
6	-	MGPR - 32	10.73

MG Snap On Type Terminal End



CABLE mm ²	STUD HOLE	PROD. CODE	RATE / PCS.
1.5	-	MG - 8351	3.60
1.5	-	MG - 8352	4.84
2.5	-	MG - 8347	3.69
2.5	-	MG - 8348	4.84

“ We are Dedicated to Deliver Defect Free Product On Time at Most Competitive Pricing ”

MG Copper Fork 'U' Type Terminal



CABLE mm ²	STUD HOLE	PROD. CODE	RATE / PCS.
1.5	3.1	MGU - 7235	2.19
1.5	3.6	MGU - 7240	1.92
1.5	3.1	MGU - 7241	1.88
1.5	3.6	MGU - 7244	1.91
1.5	4.1	MGU - 7237	3.30
1.5	4.1	MGU - 7236	2.13
1.5	5.1	MGU - 7238	3.69
1.5	6.1	MGU - 7861	2.61
2.5	3.1	MGU - 7862	2.13
2.5	3.6	MGU - 7863	2.13
2.5	4.1	MGU - 7239	2.73
2.5	5.1	MGU - 7242	2.95
2.5	6.1	MGU - 7864	3.11
4-6	4.1	MGU - 7243	4.32
4-6	4.1	MGU - 7245	5.17
4-6	5.1	MGU - 7246	5.10
4-6	5.1	MGU - 7247	6.72
4-6	6.1	MGU - 7248	5.97
10	4.1	MGU - 7865	9.95
10	5.1	MGU - 7866	8.13
10	6.1	MGU - 7867	7.28
10	8.1	MGU - 7868	8.98
16	5.1	MGU - 7869	11.44
16	6.1	MGU - 7870	11.54
16	8.1	MGU - 7871	16.25
16	8.1	MGU - 7872	18.17

MG Copper Fork 'U' Type Terminal (Insulated)



CABLE mm ²	STUD HOLE	PROD. CODE	RATE / PCS.
1.5	3.1	MGUI - 7873	2.95
1.5	3.6	MGUI - 7874	2.57
1.5	3.1	MGUI - 7875	2.53
1.5	3.6	MGUI - 7876	2.57
1.5	4.1	MGUI - 7877	3.71
1.5	4.1	MGUI - 7878	2.72
1.5	5.1	MGUI - 7879	4.68
1.5	6.1	MGUI - 7880	3.10
2.5	3.1	MGUI - 7881	2.80
2.5	3.6	MGUI - 7882	2.78
2.5	4.1	MGUI - 7883	3.64
2.5	5.1	MGUI - 7884	3.83
2.5	6.1	MGUI - 7885	3.95
4-6	4.1	MGUI - 7886	5.98
4-6	4.1	MGUI - 7887	6.83
4-6	5.1	MGUI - 7888	6.75
4-6	5.1	MGUI - 7889	8.32
4-6	6.1	MGUI - 7890	7.49
10	4.1	MGUI - 7891	12.66
10	5.1	MGUI - 7866	11.35
10	6.1	MGUI - 7893	9.95
10	8.1	MGUI - 7868	11.90
16	5.1	MGUI - 7895	16.21
16	6.1	MGUI - 7896	16.33
16	8.1	MGUI - 7897	20.10
16	8.1	MGUI - 7898	23.53

MG Copper Fork 'U' Type Terminal (Reinforcement)



CABLE mm ²	STUD HOLE	PROD. CODE	RATE / PCS.
1.5	3.1	MGUR - 7899	3.98
1.5	3.6	MGUR - 7900	3.55
1.5	3.1	MGUR - 7901	3.55
1.5	3.6	MGUR - 7902	3.58
1.5	4.1	MGUR - 7903	4.78
1.5	4.1	MGUR - 7904	4.02
1.5	5.1	MGUR - 7905	5.32
1.5	6.1	MGUR - 7906	4.25
2.5	3.1	MGUR - 7907	4.13
2.5	3.6	MGUR - 7908	4.13
2.5	4.1	MGUR - 7909	4.78
2.5	5.1	MGUR - 7910	5.16
2.5	6.1	MGUR - 7911	5.03
4-6	4.1	MGUR - 7912	7.90
4-6	4.1	MGUR - 7913	8.79
4-6	5.1	MGUR - 7914	8.58
4-6	5.1	MGUR - 7915	10.04
4-6	6.1	MGUR - 7916	9.64
10	4.1	MGUR - 7917	16.88
10	5.1	MGUR - 7918	16.10
10	6.1	MGUR - 7919	14.89
10	8.1	MGUR - 7920	16.51
16	5.1	MGUR - 7921	25.16
16	6.1	MGUR - 7922	25.33
16	8.1	MGUR - 7923	30.08
16	8.1	MGUR - 7924	30.94

**MG Copper Tubular
Terminal Ends Light Duty**

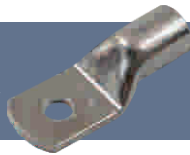

**MG Soldering Type Copper
Tubular Sockets Suitable
For Aluminium Conductor**

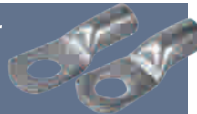

CABLE mm ²	STUD HOLE	PROD. CODE	RATE / PCS.
2.5	5.2	MGCUS-05	4.42
4	6.5	MGCUS-06	6.48
6	6.5	MGCUS-07	8.45
10	6.5	MGCUS-08	10.05
16	6.5	MGCUS-09	14.30
25	6.5	MGCUS-10	25.35
35	6.5	MGCUS-11	29.25
35	8.2	MGCUS-12	29.25
50	6.5	MGCUS-13	39.65
50	8.2	MGCUS-14	39.65
50	10.2	MGCUS-15	39.65
70	8.2	MGCUS-16	69.55
70	10.2	MGCUS-17	69.55
70	12.7	MGCUS-18	69.55
95	10.2	MGCUS-19	96.20
95	12.7	MGCUS-20	96.20
120	10.2	MGCUS-21	128.70
120	12.7	MGCUS-22	128.70
120	16.2	MGCUS-23	128.70
150	10.2	MGCUS-24	189.80
150	12.7	MGCUS-25	189.80
150	16.2	MGCUS-26	189.80
185	12.7	MGCUS-27	276.90
185	16.2	MGCUS-28	276.90
225	16.2	MGCUS-231	345.80
240	16.2	MGCUS-29	384.80
240	20.3	MGCUS-30	384.80
300	16.2	MGCUS-31	534.00
300	20.3	MGCUS-32	534.00
400	20.3	MGCUS-33	757.00
500	20.3	MGCUS-34	979.90
630	20.3	MGCUS-35	1446.00
800	-	MGCUS-62	2274.00
1000	-	MGCUS-76	4815.00

CABLE mm ²	STUD HOLE	PROD. CODE	RATE / PCS.
15	3.2	MGEW - 201	7.42
30	5.1	MGEW - 202	11.11
60	6.4	MGEW - 203	26.61
100	9.5	MGEW - 204	56.78
150	9.5	MGEW - 205	89.42
200	12.7	MGEW - 206	144.73
300	12.7	MGEW - 207	287.90
400	15.9	MGEW - 208	338.74
500	19	MGEW - 209	449.09
600	19	MGEW - 210	683.60
800	23.8	MGEW - 211	1322.48
1000	23.8	MGEW - 212	1964.61

**MG Copper Tubular
In-Line Connector**

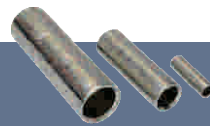

CABLE mm ²	STUD HOLE	PROD. CODE	RATE / PCS.
4	-	MGCB - 3	5.21
6	-	MGCB - 4	6.22
16	-	MGCB - 6	11.28
25	-	MGCB - 24	25.21
35	-	MGCB - 25	40.50
50	-	MGCB - 26	61.43
70	-	MGCB - 51	89.28
95	-	MGCB - 52	133.39
120	-	MGCB - 53	166.67
150	-	MGCB - 54	238.20
185	-	MGCB - 55	331.35
240	-	MGCB - 56	507.76
300	-	MGCB - 57	713.51
400	-	MGCB - 58	1073.90
500	-	MGCB - 59	1495.31
630	-	MGCB - 61	2115.66



45° Bend Lug



90° Bend Lug



Customized Lug

**MG Copper Tubular
Terminal Ends Heavy Duty**



CABLE mm ²	STUD HOLE	PROD. CODE	RATE / PCS.
25	8.2	MGCUS- 282	27.27
35	8.2	MGCUS- 283	48.10
50	8.2	MGCUS- 284	79.30
70	10.2	MGCUS- 285	126.10
95	12.7	MGCUS- 286	187.20
120	12.7	MGCUS- 287	291.20
150	12.7	MGCUS- 288	339.30
185	12.7	MGCUS- 289	501.49
240	16.2	MGCUS- 290	690.30
300	16.2	MGCUS- 291	893.10
400	20.3	MGCUS- 292	1491.90
500	20.3	MGCUS- 293	2268.00
630	20.3	MGCUS- 294	3475.00



T - Connector



Cross Connector - Plated

“ We are solution provider
for Customized Lugs ”

MG End Sealing Ferrules Insulated

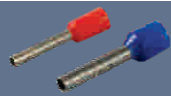

CABLE mm ²	PROD. CODE	COLOUR	RATE / PCS.
0.5	MGEHI-0.5 L-8	White	0.93
0.75	MGEHI-0.75 L-10	Gray	1.11
0.75	MGEHI-0.75 L-12	Gray	1.29
1	MGEHI-1 L-8	Black	1.06
1	MGEHI-1 L-8	Red	1.06
1	MGEHI-1 L-10	Red	1.19
1	MGEHI-1 L-10	Black	1.19
1	MGEHI-1 L-12	Red	1.33
1.5	MGEHI-1.5 L-8	Red	1.11
1.5	MGEHI-1.5 L-8	Black	1.11
1.5	MGEHI-1.5 L-10	Black	1.36
1.5	MGEHI-1.5 L-10	Red	1.36
1.5	MGEHI-1.5 L-12	Blue	1.65
1.5	MGEHI-1.5 L-15	Black	1.95
2.5	MGEHI-2.5 L-8	Blue	1.46
2.5	MGEHI-2.5 L-8	Black	1.46
2.5	MGEHI-2.5 L-10	Black	1.68
2.5	MGEHI-2.5 L-10	Blue	1.68
2.5	MGEHI-2.5 L-12	Blue	1.91
2.5	MGEHI-2.5 L-12	Black	1.91
4	MGEHI-4 L-8	Gray	1.85
4	MGEHI-4 L-12	Gray	2.22
6	MGEHI-6 L-10	Yellow	2.61
6	MGEHI-6 L-12	Black	2.97
6	MGEHI-6 L-12	Yellow	2.97
10	MGEHI-10 L-12	Red	3.99
16	MGEHI-16 L-12	Blue	4.43
16	MGEHI-16 L-12	Black	4.43
25	MGEHI-25 L-16	Yellow	13.30
35	MGEHI-35 L-18	Black	17.90

MG Copper Tubular Insulated In-line Connectors

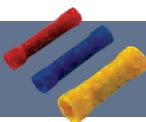

CABLE mm ²	STUD HOLE	PROD. CODE	RATE / PCS.
1.5		MGICI - 463	6.16
2.5		MGICI - 464	7.45
4.6		MGICI - 465	10.99

MG Copper Tubular In-line Connector



CABLE mm ²	STUD HOLE	PROD. CODE	RATE / PCS.
1.5		MGEH- 453	2.87
2.5		MGEH- 454	3.77
4-6		MGEH- 455	6.37
10		MGEH- 460	8.84

MG Twin End Sealing Ferrules Insulated



CABLE mm ²	PROD. CODE	COLOUR	RATE / PCS.
0.5	MGEHIT-0.5 L-8	White	1.77
0.5	MGEHIT-0.5 L-10	White	1.90
0.5	MGEHIT-0.5 L-12	White	1.99
0.75	MGEHIT-0.75 L-8	Gray	1.79
0.75	MGEHIT-0.75 L-10	Gray	1.92
0.75	MGEHIT-0.75 L-12	Gray	2.01
1	MGEHIT-1 L-8	Red	2.02
1	MGEHIT-1 L-10	Red	2.22
1	MGEHIT-1 L-12	Red	2.32
1.5	MGEHIT-1.5 L-8	Black	2.22
1.5	MGEHIT-1.5 L-10	Black	2.42
1.5	MGEHIT-1.5 L-10	Red	2.42
1.5	MGEHIT-1.5 L-12	Black	2.72
2.5	MGEHIT-2.5 L-8	Blue	2.79
2.5	MGEHIT-2.5 L-8	Gray	2.79
2.5	MGEHIT-2.5 L-10	Blue	2.99
2.5	MGEHIT-2.5 L-12	Blue	3.19
4	MGEHIT-4 L-12	Gray	4.43
6	MGEHIT-6 L-12	Yellow	5.20
6	MGEHIT-6 L-14	Yellow	5.50
10	MGEHIT-10 L-14	Red	7.80
16	MGEHIT-16 L-14	Blue	11.50

MG Copper End Sealing Ferrules



CABLE mm ²	STUD HOLE	PROD. CODE	RATE / PCS.
0.5		MEH - 508	0.67
0.75		MEH - 509	0.67
1		MEH - 510	0.67
1		MEH - 511	0.83
1.5		MEH - 512	0.77
1.5		MEH - 513	0.95
2.5		MEH - 514	0.88
2.5		MEH - 515	1.27
4		MEH - 516	1.00
4		MEH - 517	1.33
6		MEH - 518	1.44
6		MEH - 519	1.77
6		MEH - 520	2.21
10		MEH - 521	2.49
10		MEH - 522	2.77
10		MEH - 523	3.04
16		MEH - 524	3.04
16		MEH - 525	3.32
16		MEH - 526	3.88
25		MEH - 527	4.41
25		MEH - 528	5.21
25		MEH - 529	6.57
25		MEH - 530	7.64
25		MEH - 531	8.46
35		MEH - 532	8.25
35		MEH - 533	8.72
35		MEH - 534	9.55
35		MEH - 535	12.58

MG Copper Reducer Type Terminal Ends



CABLE mm ²	STUD HOLE	PROD. CODE	RATE / PCS.
2.5		MGWPC - 07	14.78
4		MGWPC - 16	14.56
6		MGWPC - 18	14.25
10		MGWPC - 20	17.14
16		MGWPC - 02	25.83
25		MGWPC - 25	45.59
25		MGWPC - 03	59.99
35		MGWPC - 04	59.36
50		MGWPC - 26	74.26
70		MGWPC - 27	95.57
70		MGWPC - 06	152.64
70		MGWPC - 28	176.23
95		MGWPC - 29	187.07
95		MGWPC - 08	263.92
95		MGWPC - 31	131.45
120		MGWPC - 32	237.97
120		MGWPC - 34	152.78
120		MGWPC - 35	242.69
150		MGWPC - 37	284.20
185		MGWPC - 38	415.79
240		MGWPC - 44	671.45
300		MGWPC - 45	796.66
300		MGWPC - 47	587.21

Our Strength
100% EC Grade Copper,
Excellent Crimpability,
Bur Free Finish,
5 Micron Plating Thickness



MCB Clamps

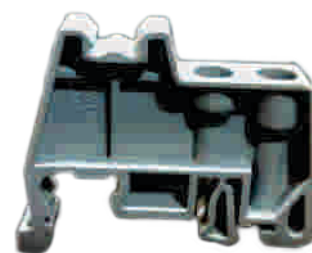

MG Copper Tubular Terminal IEC 61238



CABLE mm ²	STUD HOLE	PROD. CODE	RATE / PCS.
1.5	4.2	MGT-1.5-4	5.11
1.5	5.2	MGT-1.5-5	5.11
1.5	6.5	MGT-1.5-6	5.27
2.5	4.2	MGT-2.5-4	4.86
2.5	5.2	MGT-2.5-5	5.21
2.5	6.5	MGT-2.5-6	5.21
2.5	8.4	MGT-2.5-8	5.64
4	4.2	MGT-4-4	6.83
4	5.2	MGT-4-5	6.83
4	6.5	MGT-4-6	6.50
4	8.4	MGT-4-8	7.42
6	4.2	MGT-6-4	9.41
6	5.2	MGT-6-5	8.45
6	6.5	MGT-6-6	8.45
6	8.4	MGT-6-8	9.10
6	10.5	MGT-6-10	17.31
10	4.2	MGT-10-4	10.97
10	5.2	MGT-10-5	10.80
10	6.5	MGT-10-6	10.16
10	8.4	MGT-10-8	10.16
10	10.5	MGT-10-10	19.80
10	13	MGT-10-13	19.03
16	5.2	MGT-16-5	14.46
16	6.5	MGT-16-6	13.65
16	8.4	MGT-16-8	13.65
16	10.5	MGT-16-10	27.62
16	13	MGT-16-13	27.62
25	6.5	MGT-25-6	19.98
25	8.4	MGT-25-8	20.38
25	10.5	MGT-25-10	21.13
25	13	MGT-25-13	30.94
35	5.2	MGT-35-5	36.77
35	6.5	MGT-35-6	35.10
35	8.4	MGT-35-8	35.10
35	10.5	MGT-35-10	35.10
35	13	MGT-35-13	35.10
50	6.5	MGT-50-6	62.20
50	8.4	MGT-50-8	54.60

MG Copper Four Hole Terminal End



CABLE mm ²	STUD HOLE	PROD. CODE	RATE / PCS.
300	8.5	MGFT 300-8	772.34
300	10.5	MGFT 300-10	1299.80
400	8.5	MGFT 400-8	1339.59
400	10.5	MGFT 400-10	1316.03
500	8.5	MGFT 500-8	1745.80
500	10.5	MGFT 500-10	1717.53
630	8.5	MGFT 630-8	2620.76
630	10.5	MGFT 630-10	2589.35

MG Copper Tubular Terminal IEC 61238



CABLE mm ²	STUD HOLE	PROD. CODE	RATE / PCS.
50	10	MGT-50-10	54.60
50	13	MGT-50-13	54.60
70	6.5	MGT-70-6	99.49
70	8.4	MGT-70-8	83.20
70	10.5	MGT-70-10	83.20
70	13	MGT-70-13	83.20
95	8.4	MGT-95-8	152.77
95	10.5	MGT-95-10	128.70
95	13	MGT-95-13	128.70
120	8.4	MGT-120-8	206.20
120	10.5	MGT-120-10	206.20
120	13	MGT-120-13	176.80
120	17	MGT-120-17	185.90
150	8.4	MGT-150-8	285.63
150	10.5	MGT-150-10	285.63
150	13	MGT-150-13	249.60
150	17	MGT-150-17	249.60
185	10.5	MGT-185-10	378.19
185	13	MGT-185-13	372.06
185	17	MGT-185-17	334.38
185	21	MGT-185-21	334.38
240	10.5	MGT-240-10	559.82
240	13	MGT-240-13	553.08
240	17	MGT-240-17	500.24
240	21	MGT-240-21	500.24
300	13	MGT-300-13	807.74
300	17	MGT-300-17	730.71
300	21	MGT-300-21	730.71
400	13	MGT-400-13	1317.31
400	17	MGT-400-17	1209.45
400	21	MGT-400-21	1209.45
500	13	MGT-500-13	1795.68
500	17	MGT-500-17	1572.09
630	21	MGT-630-21	2392.74
800	-	MGT-800	4214.00
1000	-	MGT-1000	6330.68

Guarented 100%
EC Grade Copper

Mg Copper Tubular Terminal Ends Medium Duty



CABLE mm ²	STUD HOLE	PROD. CODE	RATE / PCS.
2.5	5.2	MGCEB - 05	5.20
4	6.4	MGCEB - 06	70.56
6	6.4	MGCEB - 07	9.75
10	6.4	MGCEB - 08	11.70
16	6.4	MGCEB - 09	17.55
25	6.4	MGCEB - 10	29.25
35	6.4	MGCEB - 11	13.15
35	8.2	MGCEB - 12	13.15
50	6.4	MGCEB - 13	55.12
50	8.2	MGCEB - 14	55.12
50	10.2	MGCEB - 15	53.90
70	8.2	MGCEB - 16	89.52
70	10.2	MGCEB - 17	87.85
70	12.7	MGCEB - 18	85.25
95	10.2	MGCEB - 19	128.21
95	12.7	MGCEB - 20	124.90
120	10.2	MGCEB - 21	168.77
120	12.7	MGCEB - 22	165.22
120	16.4	MGCEB - 23	158.55
150	10.2	MGCEB - 24	248.82
150	12.7	MGCEB - 25	244.56
150	16.4	MGCEB - 26	236.55
185	12.7	MGCEB - 27	361.61
185	16.4	MGCEB - 28	352.71
225	16.4	MGCEB - 231	446.75
240	16.4	MGCEB - 29	500.03
240	20.3	MGCEB - 30	488.20
300	16.4	MGCEB - 31	685.07
300	20.3	MGCEB - 32	671.17
400	20.3	MGCEB - 33	1008.15
500	20.3	MGCEB - 34	1304.53
630	20.3	MGCEB - 35	1883.27
800	-	MGCEB - 62	2947.59
1000	-	MGCEB - 76	6313.23

MG Copper Two Hole Extended Palm Terminals



CABLE mm ²	STUD HOLE	PROD. CODE	RATE / PCS.
16	10.5	MGTT-16-10	76.19
25	10.5	MGTT-25-10	80.75
35	8.4	MGTT-35-8	107.04
35	10.5	MGTT-35-10	105.39
50	13	MGTT- 50-13	184.85
70	13	MGTT-70-13	231.26
95	13	MGTT-95-13	322.98
120	13	MGTT-120-13	429.12
150	13	MGTT-150-13	522.73
185	13	MGTT-185-13	650.96
240	13	MGTT-240-13	882.19
300	13	MGTT-300-13	1182.05
400	13	MGTT-400-13	1862.35
500	13	MGTT-500-13	2391.35
630	13	MGTT-630-13	3084.12

**MG Aluminium
Terminal Ends IS 8309**



CABLE mm ²	STUD HOLE	PROD. CODE	RATE / PCS.
2.5	3.2	MGALS-151	2.78
2.5	3.7	MGALS-309	2.58
4	4.2	MGALS-155	2.44
4	5.1	MGALS-317	2.66
6	5.2	MGALS-158	2.35
6	6.5	MGALS-313	2.35
10	4.2	MGALS-159	3.28
10	6.4	MGALS-214	3.38
10	8.2	MGALS-215	3.38
16	6.4	MGALS-252	4.49
16	8.2	MGALS-216	4.49
16	10.2	MGALS-217	4.39
25	6.4	MGALS-253	5.99
25	8.2	MGALS-218	5.79
25	10.2	MGALS-219	5.55
25	12.7	MGALS-220	5.55
35	6.4	MGALS-254	7.41
35	8.2	MGALS-221	7.41
35	10.2	MGALS-222	7.41
50	8.2	MGALS-255	12.35
50	10.2	MGALS-312	12.35
50	12.7	MGALS-224	12.35
70	8.2	MGALS-256	19.63
70	10.2	MGALS-225	19.63
70	12.7	MGALS-226	19.63
95	10.2	MGALS-227	21.92
95	12.7	MGALS-228	21.92
95	16.2	MGALS-229	21.92
120	10.2	MGALS-257	30.16
120	12.7	MGALS-230	30.16
120	16.2	MGALS-231	30.16
150	10.2	MGALS-258	41.34
150	12.7	MGALS-232	41.34
150	16.2	MGALS-233	41.34
185	10.2	MGALS-311	51.61
185	12.7	MGALS-234	51.61
185	16.2	MGALS-235	51.61
225	12.7	MGALS-320	78.80
240	12.7	MGALS-236	86.06
240	16.2	MGALS-237	86.06
300	16.2	MGALS-300	119.34
300	20.3	MGALS-259	119.34
400	20.3	MGALS-260	184.86
500	20.3	MGALS-296	278.00
630	20.3	MGALS-261	340.68
800	-	MGALS-318	521.88
1000	-	MGALS-319	824.46

**MG Aluminum Tin Copper
Plating Type Bi-Metallic**



CABLE mm ²	STUD HOLE	PROD. CODE	RATE / PCS.
2.5	3.2	MGBALS-151	3.95
2.5	3.7	MGBALS-309	3.61
4	4.2	MGBALS-155	3.26
4	5.1	MGBALS-317	3.80
6	5.2	MGBALS-158	3.50
6	6.4	MGBALS-313	3.42
10	4.2	MGBALS-159	4.98
10	6.4	MGBALS-214	6.10
10	8.2	MGBALS-215	5.79
16	6.4	MGBALS-252	8.24
16	8.2	MGBALS-216	7.90
16	10.2	MGBALS-217	7.32
25	6.4	MGBALS-253	10.78
25	8.2	MGBALS-218	10.49
25	10.2	MGBALS-219	9.88
25	12.7	MGBALS-220	9.48
35	6.4	MGBALS-254	12.44
35	8.2	MGBALS-221	12.15
35	10.2	MGBALS-222	11.78
50	8.2	MGBALS-255	19.88
50	10.2	MGBALS-312	19.22
50	12.7	MGBALS-224	18.64
70	8.2	MGBALS-256	29.87
70	10.2	MGBALS-225	29.32
70	12.7	MGBALS-226	28.47
95	10.2	MGBALS-227	33.38
95	12.7	MGBALS-228	32.64
95	16.2	MGBALS-229	31.33
120	10.2	MGBALS-257	46.41
120	12.7	MGBALS-230	45.60
120	16.2	MGBALS-231	44.16
150	10.2	MGBALS-258	54.44
150	12.7	MGBALS-232	55.85
150	16.2	MGBALS-233	52.85
185	10.2	MGBALS-311	70.10
185	12.7	MGBALS-234	69.29
185	16.2	MGBALS-235	67.68
225	12.7	MGBALS-320	103.44
240	12.7	MGBALS-236	122.51
240	16.2	MGBALS-237	120.59
300	16.2	MGBALS-300	155.98
300	20.3	MGBALS-259	152.96
400	20.3	MGBALS-260	252.02
500	20.3	MGBALS-296	396.42
630	20.3	MGBALS-261	498.62
800	-	MGBALS-318	767.58
1000	-	MGBALS-319	1146.30

**Bus Bar Distribution Box
100 A / 200 A**



MG Aluminum In Line Connector



CABLE mm ²	STUD HOLE	PROD. CODE	RATE / PCS.
2.5	-	MGALS - 145	2.08
2.5	-	MGALS - 06	1.95
4	-	MGALS - 05	1.95
6	-	MGALS - 13	1.69
10	-	MGALS - 146	1.95
10	-	MGALS - 14	2.47
16	-	MGALS - 04	3.51
25	-	MGALS - 03	5.38
35	-	MGALS - 02	7.06
50	-	MGALS - 12	11.99
70	-	MGALS - 01	20.12
95	-	MGALS - 15	22.80
120	-	MGALS - 09	28.98
150	-	MGALS - 10	35.98
185	-	MGALS - 11	48.10
225	-	MGALS - 147	69.10
240	-	MGALS - 16	82.80
300	-	MGALS - 17	104.90
400	-	MGALS - 18	169.90
500	-	MGALS - 19	232.90
630	-	MGALS - 20	298.90
800	-	MGALS - 148	448.90
1000	-	MGALS - 149	729.90

MG Aluminum Long Barrel Ferrule For XLPE

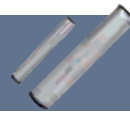

CABLE mm ²	STUD HOLE	PROD. CODE	RATE / PCS.
25	-	MGAXL - 1	14.34
35	-	MGAXL - 2	19.07
50	-	MGAXL - 3	28.87
70	-	MGAXL - 4	39.03
95	-	MGAXL - 5	52.70
120	-	MGAXL - 6	64.65
150	-	MGAXL - 7	85.17
185	-	MGAXL - 8	120.14
225	-	MGAXL - 9	146.58
240	-	MGAXL - 10	162.96
300	-	MGAXL - 11	215.73
400	-	MGAXL - 12	291.29
500	-	MGAXL - 13	391.44
630	-	MGAXL - 14	578.12
800	-	MGAXL - 15	780.72
1000	-	MGAXL - 16	1070.77

MG Aluminum Reducer Type Terminal Ends



CABLE mm ²	STUD HOLE	PROD. CODE	RATE / PCS.
2.5	-	MGAWP - 01	8.62
2.5	-	MGAWP - 07	8.37
4	-	MGAWP - 15	8.62
4	-	MGAWP - 16	8.42
6	-	MGAWP - 17	8.56
6	-	MGAWP - 18	8.36
10	-	MGAWP - 19	10.28
10	-	MGAWP - 20	10.08
10	-	MGAWP - 21	10.15
10	-	MGAWP - 22	9.95
16	-	MGAWP - 23	13.61
16	-	MGAWP - 24	14.56
16	-	MGAWP - 02	12.24
25	-	MGAWP - 25	16.01
25	-	MGAWP - 03	17.94
35	-	MGAWP - 04	19.67
50	-	MGAWP - 26	28.21
50	-	MGAWP - 05	36.23
70	-	MGAWP - 27	38.04
70	-	MGAWP - 06	44.92
70	-	MGAWP - 28	48.80
95	-	MGAWP - 29	55.29
95	-	MGAWP - 08	63.57
95	-	MGAWP - 31	48.92
95	-	MGAWP - 32	62.11
120	-	MGAWP - 33	67.72
120	-	MGAWP - 34	61.02
120	-	MGAWP - 35	72.52
120	-	MGAWP - 36	80.82
150	-	MGAWP - 10	94.23
150	-	MGAWP - 37	85.89
185	-	MGAWP - 30	115.87
185	-	MGAWP - 38	107.48
225	-	MGAWP - 39	146.70
225	-	MGAWP - 46	176.81
225	-	MGAWP - 42	162.44
240	-	MGAWP - 44	175.27
240	-	MGAWP - 43	158.96
300	-	MGAWP - 45	209.42
300	-	MGAWP - 47	191.30

MG Aluminum Long Barrel Tubular Terminal Ends For Xlpe



CABLE mm ²	STUD HOLE	PROD. CODE	RATE / PCS.
25	8.2	MGAXT - 25	11.67
35	8.2	MGAXT - 35	16.15
50	10.2	MGAXT - 50	22.92
70	10.2	MGAXT - 70	34.27
95	13	MGAXT - 95	49.36
120	13	MGAXT - 120	62.43
150	13	MGAXT - 150	87.08
185	13	MGAXT - 185	118.38
225	13	MGAXT - 225	151.17
240	13	MGAXT - 240	161.12
300	20.3	MGAXT - 300	201.39
400	20.3	MGAXT - 400	346.63
500	20.3	MGAXT - 500	464.87
630	20.3	MGAXT - 630	659.47
800	20.3	MGAXT - 800	881.86
1000	20.3	MGAXT-1000	1209.49

Din Channel



DIN Rail 35/7.5

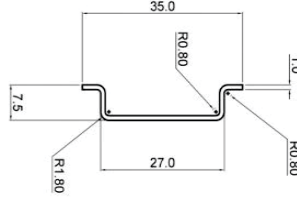

Perforation for Screw Width

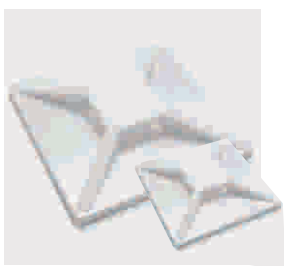

Cable Tie Mount



Cable Tie

CERTIFICATIONS

CE

ROHS

UL

ISO QMS 9001:2015



EOHS 14001:2015 & 45001:2018

POWERGRID

IATF

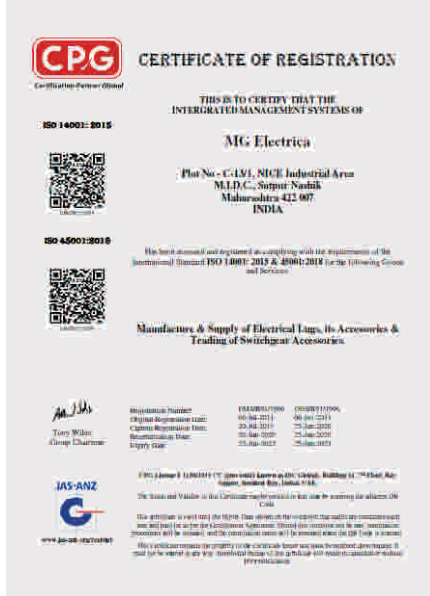

ESTEEMED CUSTOMERS





C-13/1, NICE Area, MIDC Satpur, Nashik- 422007

4000 Sq.mtr Plot

26000 Sq.ft buildup Area

- State of the Art Machinery • Complete Testing Facility